

Tolerances of the non-deformed bands according to DIN EN 10203 refer to a nominal width of 238mm¹⁾

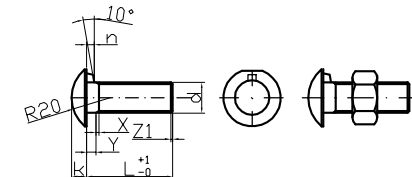

Deck plate thickness 5mm ± 0.5mm

Part No.	d	L	Y	D	D1	k	i	n	g
40.00	M16	27	5	30	29	8	4	4	4.2
40.09	M16	45	5	30	29	8	4	4	4.2

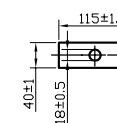
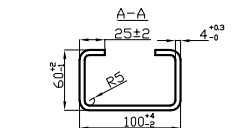
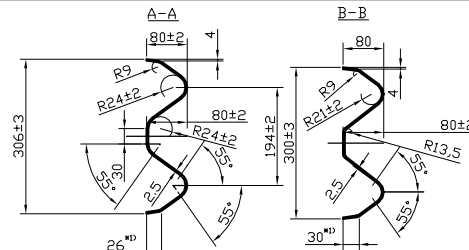
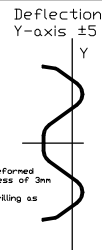
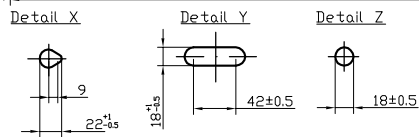
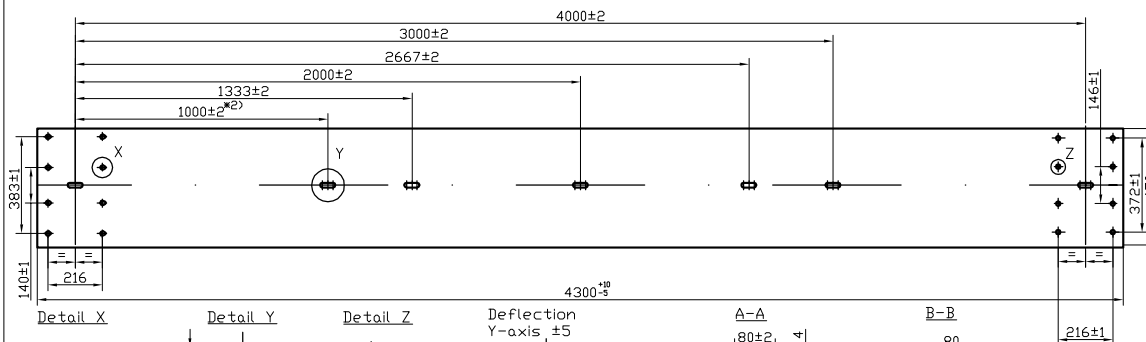

¹⁾ In these measurements the bandwidth tolerance is recorded. Tolerances of the non-deformed bands according to DIN EN 10203 refer to a nominal width of 470mm¹⁾ and a nominal thickness of 3mm ± 0.17.
²⁾ Perforation is not absolutely necessary. Tubes with or without additional holes are drilling as equivalent in principle view.

RAL-Nr.	Quantity	Description	Dimension	Single-weight	Overall weight	Material / Quality	Norm	Drawing
91.01	12	Guard rail beam Profil A	Bl. 470x25x4300	38.75	465	S355JR	EN 10025 / EN 1461	
91.06	36	Post C100/60	Bl. 238x4x1700	13.00	468	S355JR	EN 10025 / EN 1461	
10.00	36	Butt plate M16	Fl. 40x5x115	0.20	7.2	S235JR	EN 10025 / EN 1461	K1.2-101
40.00	96	HRK-bot with nib, with nut 5	M16x27	0.1	7.68		ISD 4032-5	B1.2-101
40.30	132	Flat washer	U 18	0.01	1.32		ISD 7091	
40.09	36	HRK-Screw m. Nose with nut	M16x45	0.15	4.32		ISD 4032-8	

Weight of the construction: 953.52

Test length

48 m

Weight/Running meter: 19.86

PASS+CO®

Surface	galvanized	General tolerance	Material				
			S355JR/S235JR/4.6/8.8				
Remarks		Created by	Approved by	Part number			
		T. Baracz		PL1 1.00 A			
		Title, Additional title		Document			
		passco L1 N2-A-W2 (ES 1.33) YE					
		Scale	She.	Date of issue	Form.		
		1:20(1:10) (1:5)	00	12.05.2015	A3		

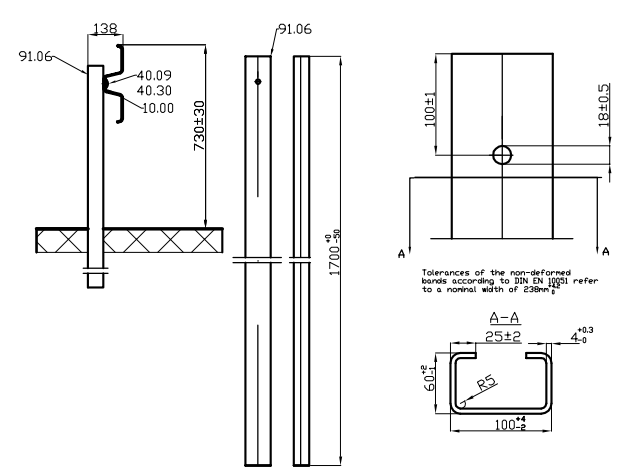
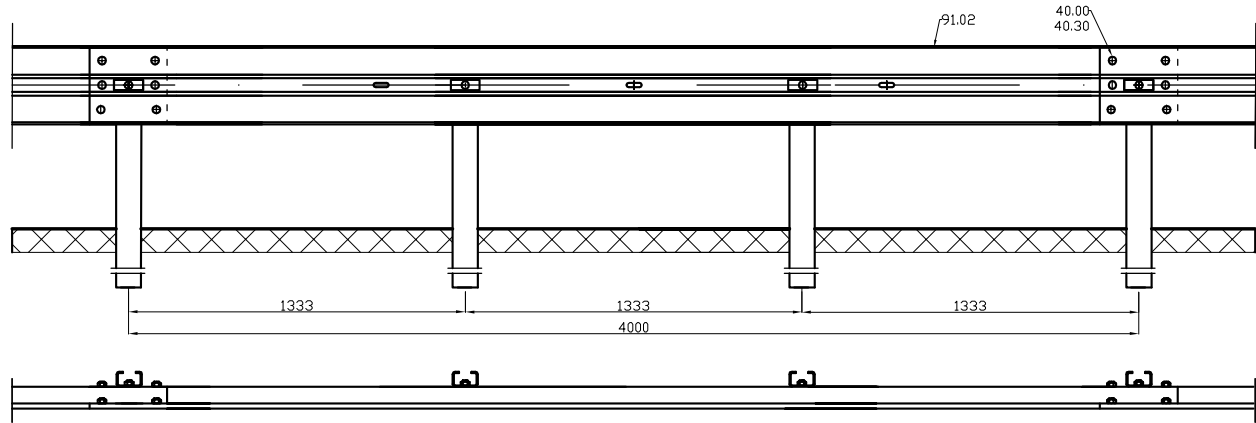

Tolerances of the non-deformed bands according to DIN EN 10201 refer to a nominal width of 238mm.

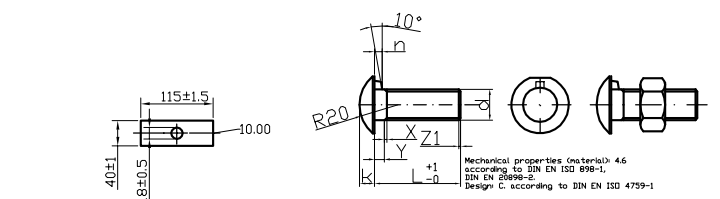
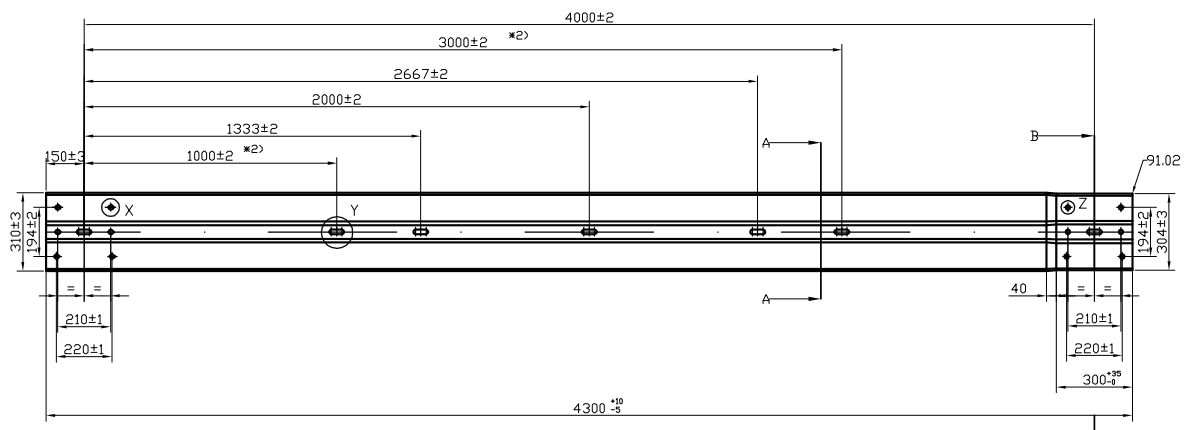

Deck plate thickness 5mm ± 0.5mm

Mechanical properties (material) 4.6 according to DIN EN ISO 898-1, DIN EN 898-2, Design C, according to DIN EN ISO 4759-1

Part No.	d	L	Y	D	D1	k	i	n	g
40.00	M16	27	5	30	29	8	4	4	4.2
40.09	M16	4	5	30	29	8	4	4	4.2

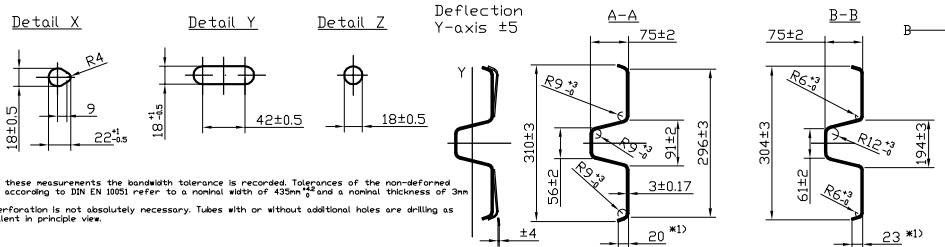

*1) In these measurements the bandwidth tolerance is recorded. Tolerances of the non-deformed bands according to DIN EN 10201 refer to a nominal width of 435mm^{+0.4} and a nominal thickness of 3mm ± 0.17.
 *2) Perforation is not absolutely necessary. Tubes with or without additional holes are drilling as equivalent in principle view.

Item no.	Quantity	Description	Dimension	Single-weight	Overall weight	Material / Quality	Norm	Drawing
91.02	12	Guard rail beam Profil B	Bl. 435x25x4300	35.90	430.8	S355JR	EN 10025 / EN 1461	
91.06	36	Post C100/60	Bl. 238x4x1700	13.00	468	S355JR	EN 10025 / EN 1461	
10.00	36	Butt plate M16	Fl. 40x5x115	0.20	7.2	S235JR	EN 10025 / EN 1461	K1.2-101
40.00	96	HRK-bolt with nib, with nut 5	M16x27	0.1	7.68		ISD 4032-5	B1.2-101
40.30	132	Flat washer	U 18	0.01	1.32		ISD 7091	
40.09	36	HRK-Screw with nib, with nut	M16x45	0.15	4.32		ISD 4032-8	

Weight of the construction: 919.32
 Weight/Running meter: 19.15
 Test length: 48 m



Surface	galvanized	General tolerance	Material	S355JR/S235JR/4.6/8.8
Remarks	Created by	T. Baracz	Part number	PL1 1.00 B
	Title, Additional title	passco L1 N2-A-W2 (ES 1.33) YE		
Scale		1:20(1:10) (1:5)	She.	00
Date of issue		12.05.2016		
Form.		A3		

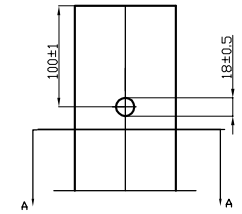
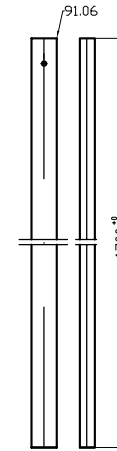
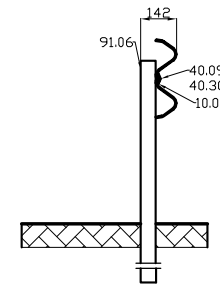
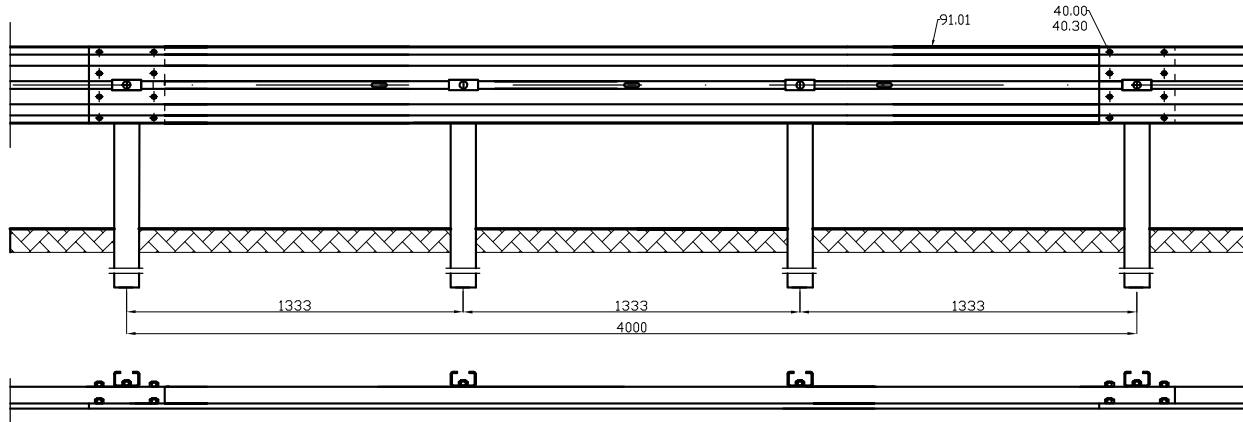

Tolerances of the non-deformed bands according to DIN EN 10051 refer to a nominal width of 238mm.

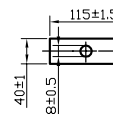
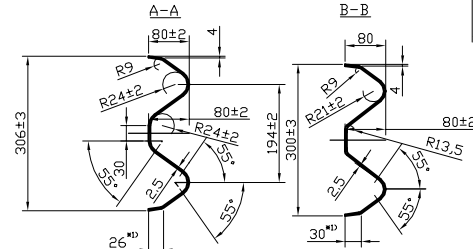
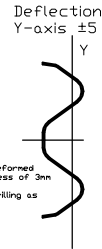
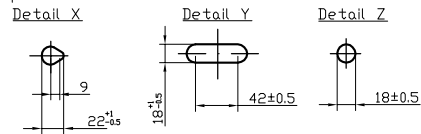
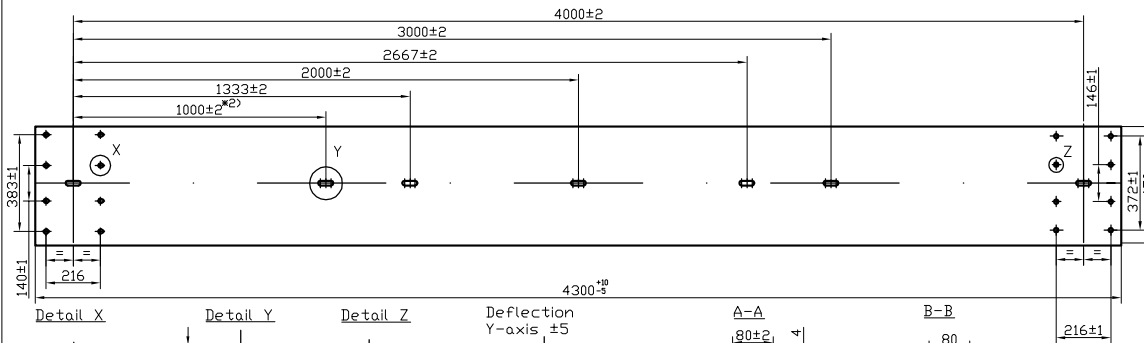
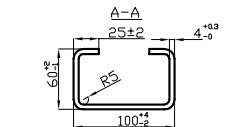

Deck plate thickness 5mm ± 0.5mm

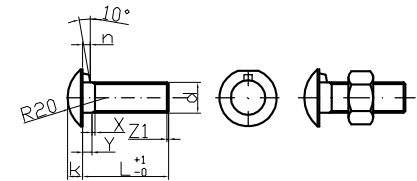

Part No.	d	L	Y	D	D1	k	i	n	g
40.00	M16	27	5	30	29	8	4	4	4.2
40.09	M16	45	5	30	29	8	4	4	4.2

#3 In these measurements the bandwidth tolerance is recorded. Tolerances of the non-deformed bands according to DIN EN 10051 refer to a nominal width of 470mm and a nominal thickness of 3mm ± 0.17.

#4 Perforation is not absolutely necessary. Tubes with or without additional holes are drilling as equivalent in principle view.

RAL-Nr.	Quantity	Description	Dimension	Single-weight	Overall weight	Material / Quality	Norm	Drawing
91.01	12	Guard rail beam Profil A	Bl. 470x25x4300	38.75	465	S355JR	EN 10025 / EN 1461	
91.06	36	Post C100/60	Bl. 238x4x1700	13.00	468	S355JR	EN 10025 / EN 1461	
10.00	36	Butt plate M16	Fl. 40x5x115	0.20	7.2	S235JR	EN 10025 / EN 1461	K1.2-101
40.00	96	HRK-bot with nib, with nut 5	M16x27	0.08	7.68	4.6	ISD 4032-5	B1.2-101
40.30	132	Flat washer	U 18	0.01	1.32	4.6	ISD 7091	
40.09	36	HRK-Screw with nib, with nut	M16x45	0.12	4.32	8.8	ISD 4032-8	

Weight of the construction: 953.52

Weight/Running meter: 19.86

Test length
48 m



Surface	galvanized	General tolerance	Material	S355JR/S235JR/4.6/8.8
Remarks	Created by	Approved by	Part number	
	T. Baracz		PL1 1.00 A	
Title, Additional title		Document		
Passco L1 H1-A-W3 (ES 1.33) YE				
Scale	She.	Date of issue	Form.	
1:200(1:100) (1:5)	00	12.05.2015	A3	

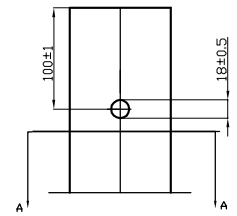
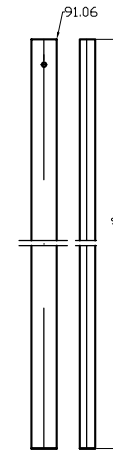
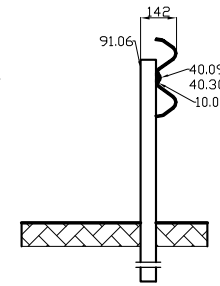
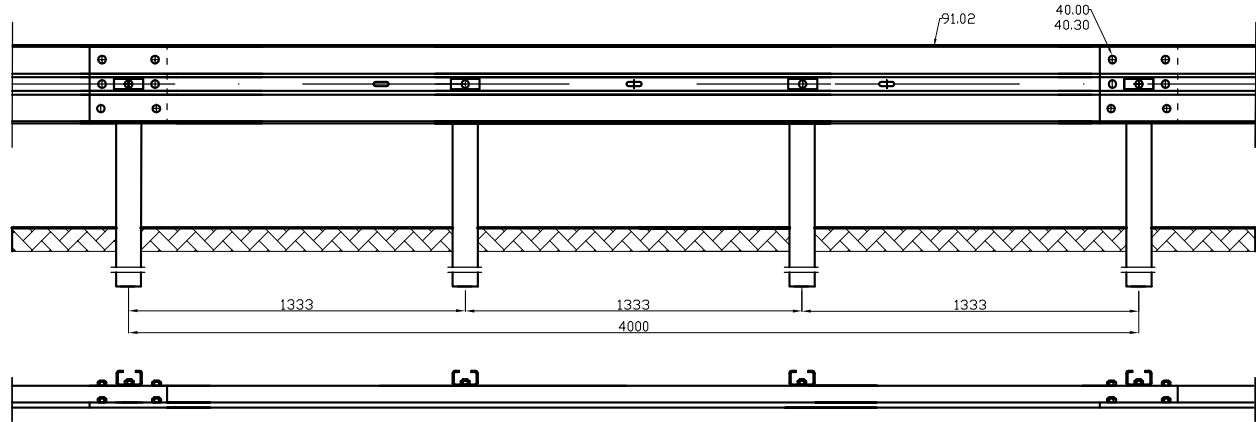

Tolerances of the non-deformed bands according to DIN EN 10201 refer to a nominal width of 238mm²

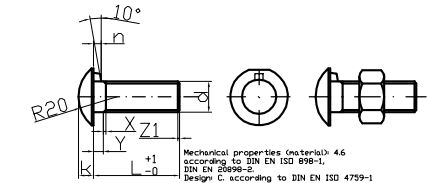
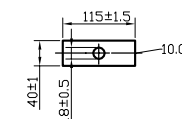
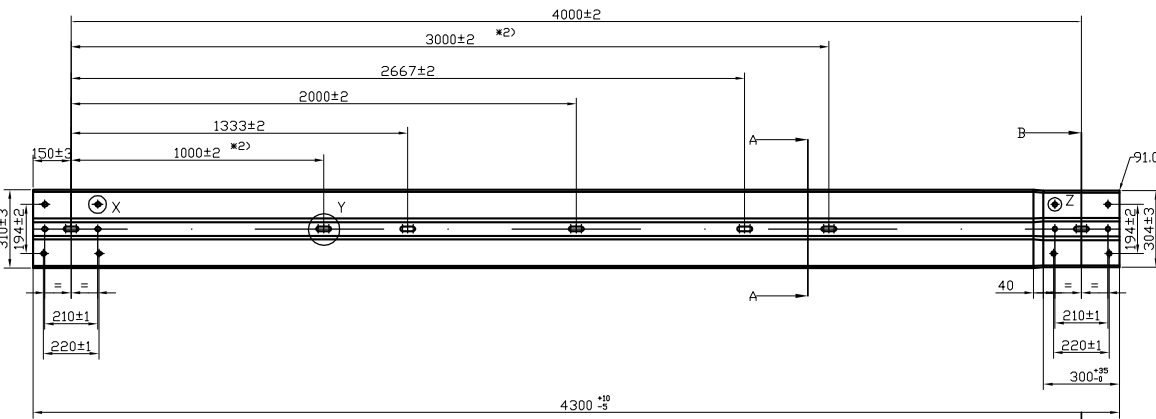
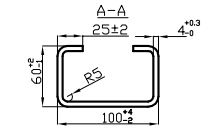

Mechanical properties (material): 4.6 according to DIN EN ISO 898-1, DIN EN 898-2, Design C, according to DIN EN ISO 4759-1

Deck plate thickness 5mm ± 0.5mm

Part No.	d	L	Y	D	D1	k	i	n	g
40.00	M16	27	5	30	29	8	4	4	4.2
40.09	M16	4	5	30	29	8	4	4	4.2

Detail X

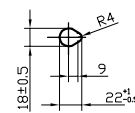

Detail Y

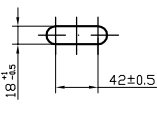

Detail Z

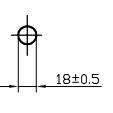

Deflection Y-axis ±5

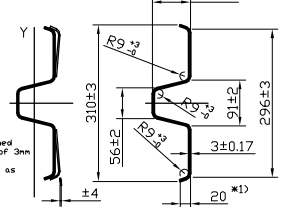

A-A

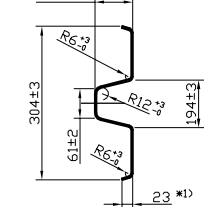

B-B

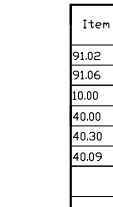

*1) In these measurements the bandwidth tolerance is recorded. Tolerances of the non-deformed bands according to DIN EN 10051 refer to a nominal width of 435mm² and a nominal thickness of 3mm ± 0.17
 *2) Partonation is not absolutely necessary. Tubes with or without additional holes are drilling as equivalent in principle view.

Item no.	Quantity	Description	Dimension	Single-weight	Overall weight	Material / Quality	Norm	Drawing
91.02	12	Guard rail beam Profil B	Bl. 435x2.5x4300	35.90	430.8	S355JR	EN 10025 / EN 1461	
91.06	36	Post C100/60	Bl. 238x4x1700	13.00	468	S355JR	EN 10025 / EN 1461	
10.00	36	Butt plate M16	Fl. 40x5x115	0.20	7.2	S235JR	EN 10025 / EN 1461	K1.2-101
40.00	96	HRK-bot with nib, with nut 5	M16x27	0.1	9.6	4.6	ISD 4032-5	B1.2-101
40.30	132	Flat washer	U 18	0.01	1.32	4.6	ISD 7091	
40.09	36	HRK-Screw with nib, with nut	M16x45	0.15	5.4	8.8	ISD 4032-8	

Weight of the construction: 919.32

Weight/Running meter: 19.15

Test length 48 m



Surface	galvanized	General tolerance	Material	S355JR/S235JR/4.6/8.8
Remarks	Created by	T. Baracz	Part number	PL1 1.00 B
	Title, Additional title	passco L1 H1-A-W3 (ES 1.33) YE	Document	
	Scale	1:20(1:10) (1:5)	She.	00
	Date of issue	12.05.2016	Form.	A3